

Solenoid Valves for Automation

2/2 way - Normally Closed - Diaphragm pilot operated

Fittings: G = 3/8" - 1/2"

Series **173**

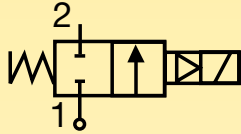

N.C.

Normally closed

Coil energised - open
Coil de-energised - closed

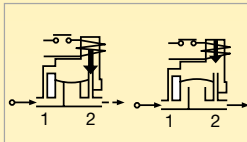

General description:

PARKER series **173** solenoid valves are diaphragm pilot operated and therefore require a minimum differential pressure to operate.

They are used for general applications with media such as **water, air, light oils (2°E) and inert gases**, provided they are compatible with the construction materials used.

Series **173** valves are **normally closed**. They are compact, with high flow rates and low power consumption.

Temperatures:

The working temperature for media is:

maximum **+90°C**
minimum **-10°C**

The maximum ambient temperature is:
+50°C

Application:

Series **173** solenoid valves are ideal for the automatic control of media in a wide range of applications such as:

- Computerised controls;
- Cooling systems for machine tools;
- Dry-cleaning machines;
- Autoclaves;
- Compressed air systems;
- Car wash systems;
- Hygiene-health systems;
- Tanning industry.

Coils:

Series **173** valves are available with class "F" coils (**155°C**) with thermoplastic insulation, reinforced with 30% glassfibre.

All the coils are for continuous service, 100% E.D.

The rated voltage tolerance is:
±10% for A.C. power supply and
+10% -5% for D.C.

The "W" coil can be used on a.c. with frequency of 50/60Hz (dualfrequency) and has Faston terminals for **DIN 43650B** connectors with protection to **IP65**.

Installation:

The valves can be mounted in any position without jeopardising their operation. It is however advisable to install them with the coil in a vertical position above the body.

Approvals:



• For the coil:
WB 4,5 115V/50-60Hz, 220-230V/50-60Hz



• For the coil:
WB 4,5 115V/50-60Hz, 220-230V/50-60Hz



• UL Recognized Comp. coils mark:
WB 4,5 24V/60Hz, 110-120V/60Hz,
208-240V/60Hz



Series **173**

MATERIALS	• Valve body:	CW617N UNI EN 12165:98 brass stamping
	• Seals:	NBR (Buna N)
	• Enclosing tube:	CW614N UNI EN 12164:98
	• Plunger:	AISI 430F stainless steel
	• Spring:	AISI 302 stainless steel
	• Shading ring:	Copper

ELECTRICAL FEATURES	Coil type []		Power [W]		Insulat. class
	A.C.(~)	D.C.(=)	A.C.(~)	D.C.(=)	
	WB 4,5	WB 5,0	4,5	5,0	F

SPECIFICATION	Fittings Ø G	Valve type	Nominal orifice Ø	Flow coefficient Kv	Minimum pressure	Max differential pressure (M.O.P.D.)		Coil type	Weight	Notes
	["]	[]	[mm]	[m³/h]	[bar]	in A.C.(~) [bar]	in D.C.(=) [bar]	[]	[Kg]	[]
	3/8	173 I	13	3,00	0,35	15	15	W	0,435	1
	1/2	173 A	13	3,50	0,35	15	15	W	0,410	1

Note: 1) NP (nominal pressure): 25 bar.

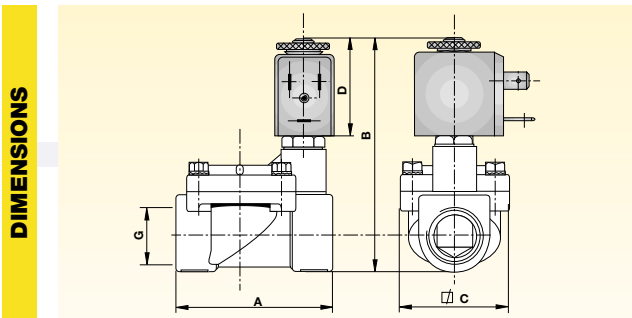

Fittings Ø G	A	B	C	D
["]	[mm]	[mm]	[mm]	[mm]
3/8	60	86	40	36
1/2	60	86	40	36

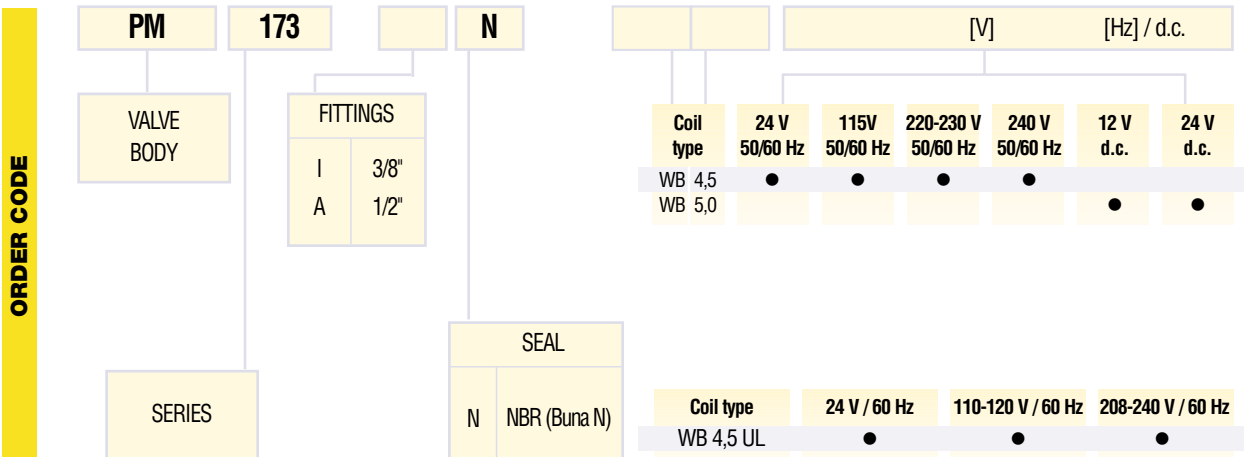

Note: Valve supplied with body (PM) and coil separate. Connector to be ordered separately.